

Project / Location

PROPOSED CONSTRUCTION OF  
SIDBI QUARTERS BEGUMPET

Client

SIDBI

NOTES -

- 1. ALL DIMENSIONS ARE IN FEET ONLY, UNLESS OTHERWISE SPECIFIED.
- 2. DO NOT SCALE THE DRAWING FOLLOW FIGURED DIMENSIONS ONLY.

NOTES -

- 1. Unless otherwise specified only BWR grade conforming to IS : 303 is to be used.
- 2. All the internal surfaces of BWR Plywood is to be provided with 0.8mm laminate, unless otherwise specified.
- 3. All the external surfaces of BWR Plywood is to be provided with 1.0mm laminate, unless otherwise specified.

REV. NO.	DESCRIPTION OF REVISION	DATE	BY
4			
3			
2	REVISED AS PER CLIENT	26-07-16	BKT
1	REVISED AS PER CLIENT	09-09-15	BKT

Purpose : FOR TENDER

Architect :

**BK THATI & ASSOCIATES**  
ARCHITECTURE ENGINEERING INTERIORS  
4-1-938/970, 2nd Floor, A-Block,  
Hyderabad-500004, India  
E-mail - bhk@bkthati.com, bhk@bkthati.in  
Cell Phone - 9849245417 FAX-24024782/15

Title : OPENABLE SHUTTER FOR  
KITCHEN PLATFORM & LOFT SLAB

Drng.No- BKTB&S/IDBI/AR-02

North	Date	Scale	Job No.	Sheet	Rev
	10-03-15	N.T.S			
Drawn By	Checked	By	Approved	By	
UMESH	DSR		BKT		

MR. BK THATI & ASSOCIATES ARCHITECTURE ENGINEERING INTERIORS  
4-1-938/970, 2nd Floor, A-Block, Hyderabad-500004, India  
E-MAIL - bhk@bkthati.com, bhk@bkthati.in  
CELL PHONE - 9849245417 FAX-24024782/15  
WITHOUT THE WRITTEN PERMISSION OF THE BK THATI & ASSOCIATES.

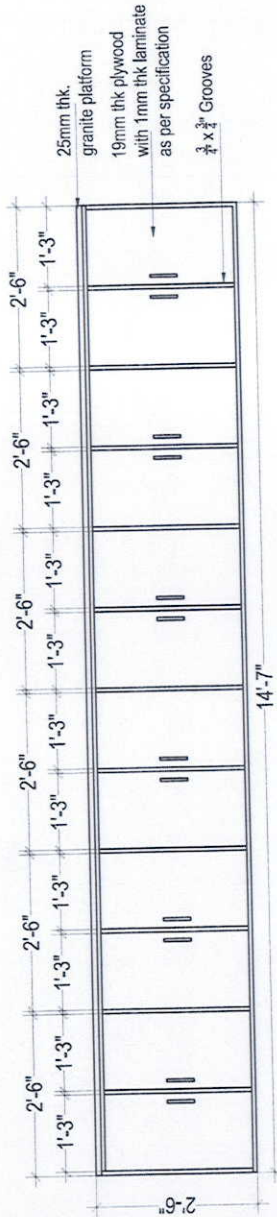
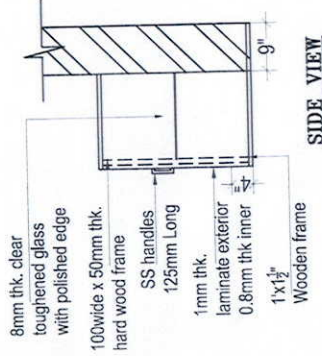
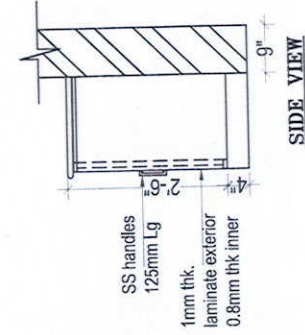

**ELEVATION**

19mm thk. marine Plywood Partition (Typical)

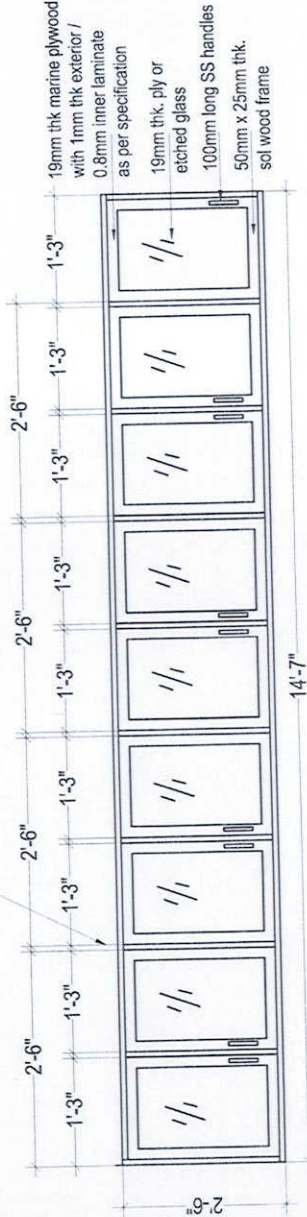

**ELEVATION**

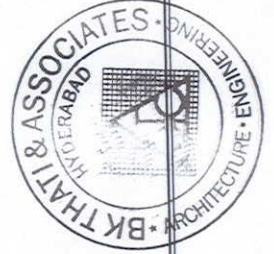

Project / Location

PROPOSED CONSTRUCTION OF  
SIDBI QUARTERS BEGUMPET

Client:

SIDBI

NOTES :-

1. ALL DIMENSIONS ARE IN FEET ONLY, UNLESS OTHERWISE SPECIFIED. DIMENSIONS FOLLOWING FOLLOWING FIGURED DIMENSIONS ONLY.
2. BEFORE EXECUTION OF WORK DIMENSION TO BE CHECKED AT SITE THOROUGHLY.

NOTES :-

1. Unless otherwise specified only BWR grade conforming to IS : 303 is to be used.
2. All the internal surfaces of BWR Plywood is to be provided with 0.8mm laminate, unless otherwise specified.
3. All the external surfaces of BWR Plywood is to be provided with 1.0mm laminate, unless otherwise specified.

REV. NO.	DESCRIPTION OF REVISION	DATE	BY
AA	REVISED AS PER CLIENT	26-07-16	BKT
AA	REVISED AS PER CLIENT	09-09-15	BKT

Purpose :

FOR TENDER

Architect :



**BK THATTI & ASSOCIATES**  
 ARCHITECTS & ENGINEERS  
 5A, 5B, 5C, 5D, 5E, 5F, 5G, 5H, 5I, 5J, 5K, 5L, 5M, 5N, 5O, 5P, 5Q, 5R, 5S, 5T, 5U, 5V, 5W, 5X, 5Y, 5Z, 5AA, 5AB, 5AC, 5AD, 5AE, 5AF, 5AG, 5AH, 5AI, 5AJ, 5AK, 5AL, 5AM, 5AN, 5AO, 5AP, 5AQ, 5AR, 5AS, 5AT, 5AU, 5AV, 5AW, 5AX, 5AY, 5AZ, 5BA, 5BB, 5BC, 5BD, 5BE, 5BF, 5BG, 5BH, 5BI, 5BJ, 5BK, 5BL, 5BM, 5BN, 5BO, 5BP, 5BQ, 5BR, 5BS, 5BT, 5BU, 5BV, 5BW, 5BX, 5BY, 5BZ, 5CA, 5CB, 5CC, 5CD, 5CE, 5CF, 5CG, 5CH, 5CI, 5CJ, 5CK, 5CL, 5CM, 5CN, 5CO, 5CP, 5CQ, 5CR, 5CS, 5CT, 5CU, 5CV, 5CW, 5CX, 5CY, 5CZ, 5DA, 5DB, 5DC, 5DD, 5DE, 5DF, 5DG, 5DH, 5DI, 5DJ, 5DK, 5DL, 5DM, 5DN, 5DO, 5DP, 5DQ, 5DR, 5DS, 5DT, 5DU, 5DV, 5DW, 5DX, 5DY, 5DZ, 5EA, 5EB, 5EC, 5ED, 5EE, 5EF, 5EG, 5EH, 5EI, 5EJ, 5EK, 5EL, 5EM, 5EN, 5EO, 5EP, 5EQ, 5ER, 5ES, 5ET, 5EU, 5EV, 5EW, 5EX, 5EY, 5EZ, 5FA, 5FB, 5FC, 5FD, 5FE, 5FF, 5FG, 5FH, 5FI, 5FJ, 5FK, 5FL, 5FM, 5FN, 5FO, 5FP, 5FQ, 5FR, 5FS, 5FT, 5FU, 5FV, 5FW, 5FX, 5FY, 5FZ, 5GA, 5GB, 5GC, 5GD, 5GE, 5GF, 5GG, 5GH, 5GI, 5GJ, 5GK, 5GL, 5GM, 5GN, 5GO, 5GP, 5GQ, 5GR, 5GS, 5GT, 5GU, 5GV, 5GW, 5GX, 5GY, 5GZ, 5HA, 5HB, 5HC, 5HD, 5HE, 5HF, 5HG, 5HH, 5HI, 5HJ, 5HK, 5HL, 5HM, 5HN, 5HO, 5HP, 5HQ, 5HR, 5HS, 5HT, 5HU, 5HV, 5HW, 5HX, 5HY, 5HZ, 5IA, 5IB, 5IC, 5ID, 5IE, 5IF, 5IG, 5IH, 5II, 5IJ, 5IK, 5IL, 5IM, 5IN, 5IO, 5IP, 5IQ, 5IR, 5IS, 5IT, 5IU, 5IV, 5IW, 5IX, 5IY, 5IZ, 5JA, 5JB, 5JC, 5JD, 5JE, 5JF, 5JG, 5JH, 5JI, 5JJ, 5JK, 5JL, 5JM, 5JN, 5JO, 5JP, 5JQ, 5JR, 5JS, 5JT, 5JU, 5JV, 5JW, 5JX, 5JY, 5JZ, 5KA, 5KB, 5KC, 5KD, 5KE, 5KF, 5KG, 5KH, 5KI, 5KJ, 5KK, 5KL, 5KM, 5KN, 5KO, 5KP, 5KQ, 5KR, 5KS, 5KT, 5KU, 5KV, 5KW, 5KX, 5KY, 5KZ, 5LA, 5LB, 5LC, 5LD, 5LE, 5LF, 5LG, 5LH, 5LI, 5LJ, 5LK, 5LL, 5LM, 5LN, 5LO, 5LP, 5LQ, 5LR, 5LS, 5LT, 5LU, 5LV, 5LW, 5LX, 5LY, 5LZ, 5MA, 5MB, 5MC, 5MD, 5ME, 5MF, 5MG, 5MH, 5MI, 5MJ, 5MK, 5ML, 5MM, 5MN, 5MO, 5MP, 5MQ, 5MR, 5MS, 5MT, 5MU, 5MV, 5MW, 5MX, 5MY, 5MZ, 5NA, 5NB, 5NC, 5ND, 5NE, 5NF, 5NG, 5NH, 5NI, 5NJ, 5NK, 5NL, 5NM, 5NN, 5NO, 5NP, 5NQ, 5NR, 5NS, 5NT, 5NU, 5NV, 5NW, 5NX, 5NY, 5NZ, 5OA, 5OB, 5OC, 5OD, 5OE, 5OF, 5OG, 5OH, 5OI, 5OJ, 5OK, 5OL, 5OM, 5ON, 5OO, 5OP, 5OQ, 5OR, 5OS, 5OT, 5OU, 5OV, 5OW, 5OX, 5OY, 5OZ, 5PA, 5PB, 5PC, 5PD, 5PE, 5PF, 5PG, 5PH, 5PI, 5PJ, 5PK, 5PL, 5PM, 5PN, 5PO, 5PP, 5PQ, 5PR, 5PS, 5PT, 5PU, 5PV, 5PW, 5PX, 5PY, 5PZ, 5QA, 5QB, 5QC, 5QD, 5QE, 5QF, 5QG, 5QH, 5QI, 5QJ, 5QK, 5QL, 5QM, 5QN, 5QO, 5QP, 5QQ, 5QR, 5QS, 5QT, 5QU, 5QV, 5QW, 5QX, 5QY, 5QZ, 5RA, 5RB, 5RC, 5RD, 5RE, 5RF, 5RG, 5RH, 5RI, 5RJ, 5RK, 5RL, 5RM, 5RN, 5RO, 5RP, 5RQ, 5RR, 5RS, 5RT, 5RU, 5RV, 5RW, 5RX, 5RY, 5RZ, 5SA, 5SB, 5SC, 5SD, 5SE, 5SF, 5SG, 5SH, 5SI, 5SJ, 5SK, 5SL, 5SM, 5SN, 5SO, 5SP, 5SQ, 5SR, 5SS, 5ST, 5SU, 5SV, 5SW, 5SX, 5SY, 5SZ, 5TA, 5TB, 5TC, 5TD, 5TE, 5TF, 5TG, 5TH, 5TI, 5TJ, 5TK, 5TL, 5TM, 5TN, 5TO, 5TP, 5TQ, 5TR, 5TS, 5TT, 5TU, 5TV, 5TW, 5TX, 5TY, 5TZ, 5UA, 5UB, 5UC, 5UD, 5UE, 5UF, 5UG, 5UH, 5UI, 5UJ, 5UK, 5UL, 5UM, 5UN, 5UO, 5UP, 5UQ, 5UR, 5US, 5UT, 5UU, 5UV, 5UW, 5UX, 5UY, 5UZ, 5VA, 5VB, 5VC, 5VD, 5VE, 5VF, 5VG, 5VH, 5VI, 5VJ, 5VK, 5VL, 5VM, 5VN, 5VO, 5VP, 5VQ, 5VR, 5VS, 5VT, 5VU, 5VV, 5VW, 5VX, 5VY, 5VZ, 5WA, 5WB, 5WC, 5WD, 5WE, 5WF, 5WG, 5WH, 5WI, 5WJ, 5WK, 5WL, 5WM, 5WN, 5WO, 5WP, 5WQ, 5WR, 5WS, 5WT, 5WU, 5WV, 5WW, 5WX, 5WY, 5WZ, 5XA, 5XB, 5XC, 5XD, 5XE, 5XF, 5XG, 5XH, 5XI, 5XJ, 5XK, 5XL, 5XM, 5XN, 5XO, 5XP, 5XQ, 5XR, 5XS, 5XT, 5XU, 5XV, 5XW, 5XX, 5XY, 5XZ, 5YA, 5YB, 5YC, 5YD, 5YE, 5YF, 5YG, 5YH, 5YI, 5YJ, 5YK, 5YL, 5YM, 5YN, 5YO, 5YP, 5YQ, 5YR, 5YS, 5YT, 5YU, 5YV, 5YW, 5YX, 5YY, 5YZ, 5ZA, 5ZB, 5ZC, 5ZD, 5ZE, 5ZF, 5ZG, 5ZH, 5ZI, 5ZJ, 5ZK, 5ZL, 5ZM, 5ZN, 5ZO, 5ZP, 5ZQ, 5ZR, 5ZS, 5ZT, 5ZU, 5ZV, 5ZW, 5ZX, 5ZY, 5ZZ

Title :

OPENABLE SHUTTER FOR  
NICHE IN HALL

Drwg. No. :- BKT&S/SHUTTER-03

Rev	Scale	Job No.	Sheet
10-03-15	N.T.S		
Drawn By	Detail	Checked By	Approved By
UMESH	DSR	BKT	BKT

MR. BK THATTI & ASSOCIATES ARCHITECTS ENGINEERS HAS THE COPY RIGHTS OF THIS DOCUMENT AND IT SHOULD BE USED BY ANYBODY WITHOUT THE WRITTEN PERMISSION OF THE BK THATTI & ASSOCIATES.

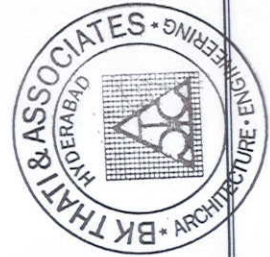
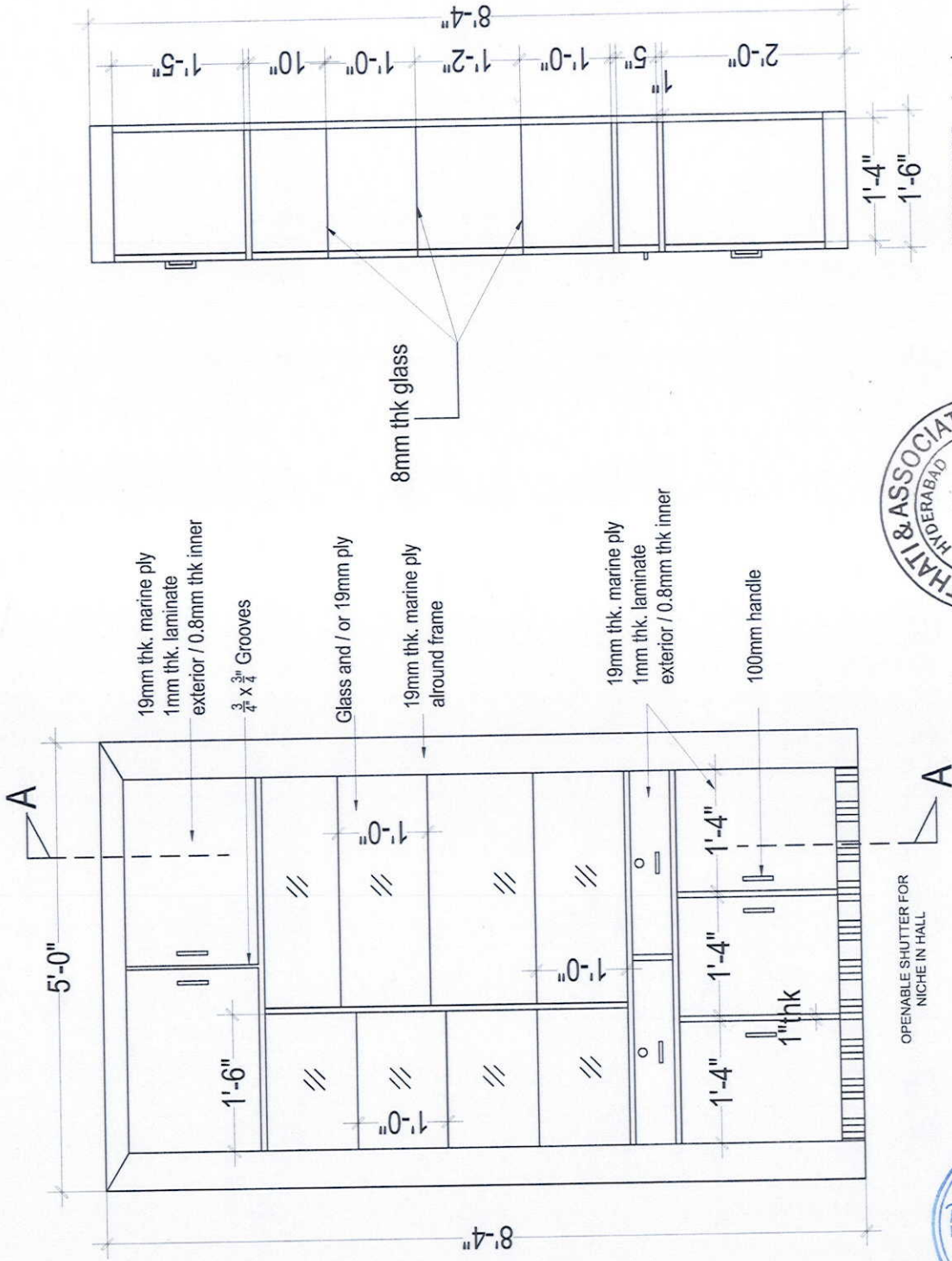

Project / Location

PROPOSED CONSTRUCTION OF  
SIDBI QUARTERS BEGUMPET

Client  
SIDBI

NOTES :-

1. ALL DIMENSIONS ARE IN FEET ONLY, UNLESS OTHERWISE SPECIFIED.
2. DO NOT SCALE THE DRAWING FOLLOW FIGURED DIMENSIONS ONLY.
3. BEFORE EXECUTION OF WORK DIMENSION TO BE CHECKED AT SITE THOROUGHLY.

NOTES :-

1. Unless otherwise specified only BWR grade conforming to IS : 303 is to be used.
2. All the internal surfaces of BWR Plywood is to be provided with 0.8mm laminate, unless otherwise specified.
3. All the external surfaces of BWR Plywood is to be provided with 1.0mm laminate, unless otherwise specified.

REVISED AS PER CLIENT

REVISED AS PER CLIENT

DESCRIPTION OF REVISION

DATE

BY

28-07-16 BKT

08-08-16 BKT

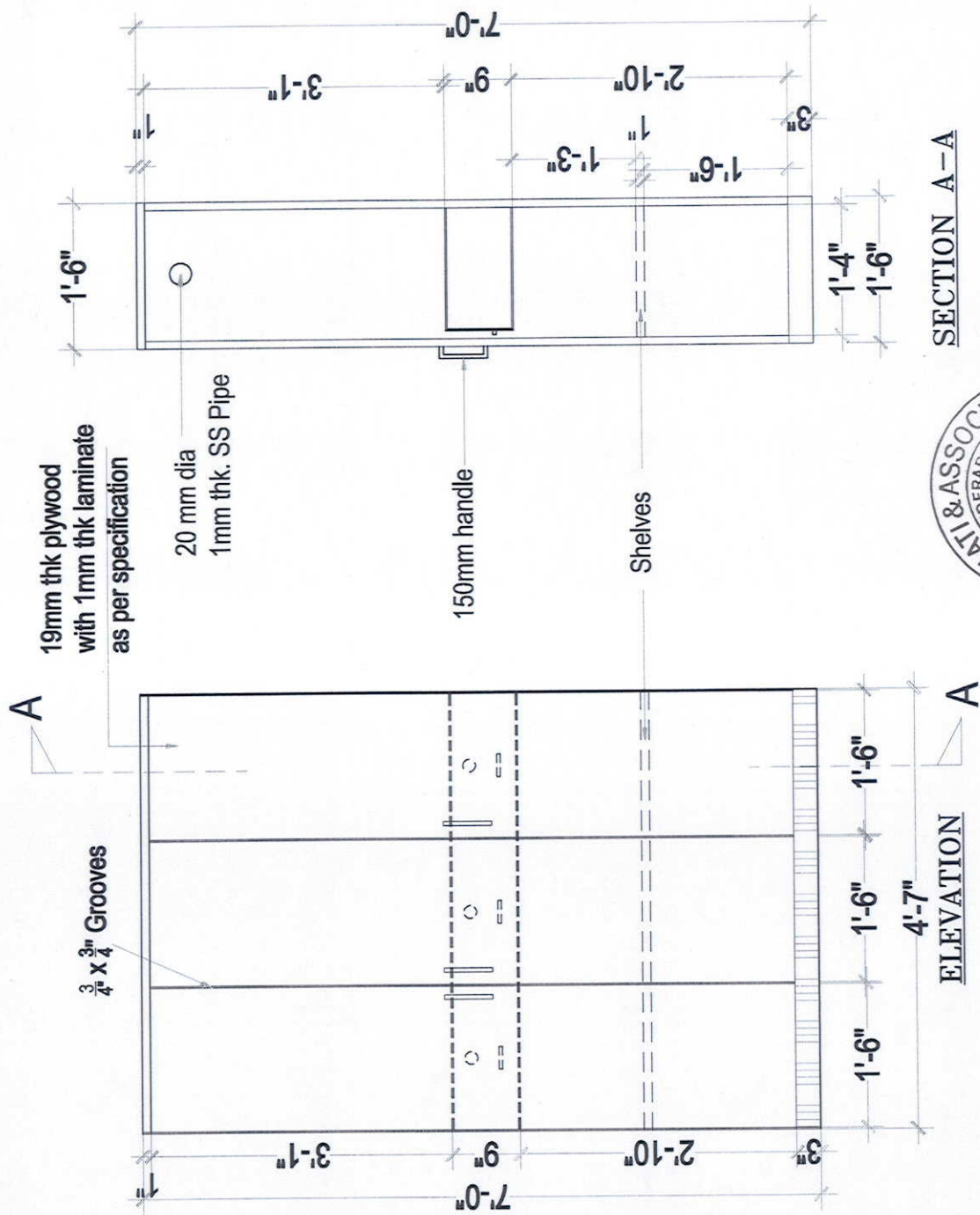

SECTION A-A

ELEVATION

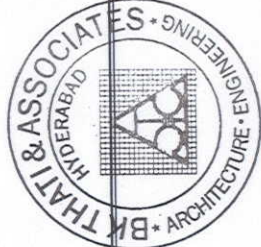

**Project / Location**  
PROPOSED CONSTRUCTION OF SIDBI QUARTERS BEGUMPET

**Client**  
SIDBI

**NOTES :-**  
1. ALL DIMENSIONS ARE IN FEET ONLY, UNLESS OTHERWISE SPECIFIED.  
2. DO NOT SCALE THE DRAWING FOLLOW FIGURED DIMENSIONS ONLY.  
3. BEFORE EXECUTION OF WORK DIMENSION TO BE CHECKED AT SITE THOROUGHLY.

**NOTES :-**  
1. Unless otherwise specified only BWR grade conforming to IS : 303 is to be used.  
2. All the internal surfaces of BWR Plywood is to be provided with 0.8mm laminate, unless otherwise specified.  
3. All the external surfaces of BWR Plywood is to be provided with 1.0mm laminate, unless otherwise specified.

REV. NO.	DESCRIPTION OF REVISION	DATE	BY
4			
3			
2			
1			

**Architect:**  
BKTATHI & ASSOCIATES  
ARCHITECTURE • ENGINEERING • INTERIOR  
B-10, 1ST FLOOR, MARKET STREET, HYDRABAD  
Phone: 2666 2222, 2666 2223  
E-mail: bktathiassociates@gmail.com

**Architect:**  
WARD ROBE

**Purpose:**  
FOR TENDER

**Scale**  
N.T.S

**Job No.**  
BKTASIDBI/AR-04

**Date**  
10-03-15

**Drawn By**  
JAMESH

**Checked By**  
DSR

**Approved By**  
BKT

**Sheet**  
Raw

**North**

**DRG. NO. :-** BKTASIDBI/AR-04

**DATE**  
10-03-15

**DESIGNED BY**  
JAMESH

**CHECKED BY**  
DSR

**APPROVED BY**  
BKT

**SCALE**  
N.T.S

**PROJECT**  
PROPOSED CONSTRUCTION OF SIDBI QUARTERS BEGUMPET

**CLIENT**  
SIDBI

**ARCHITECT**  
BKTATHI & ASSOCIATES

**DATE**  
10-03-15

**BY**  
JAMESH

**FOR TENDER**

**WARD ROBE**

**SECTION A-A**

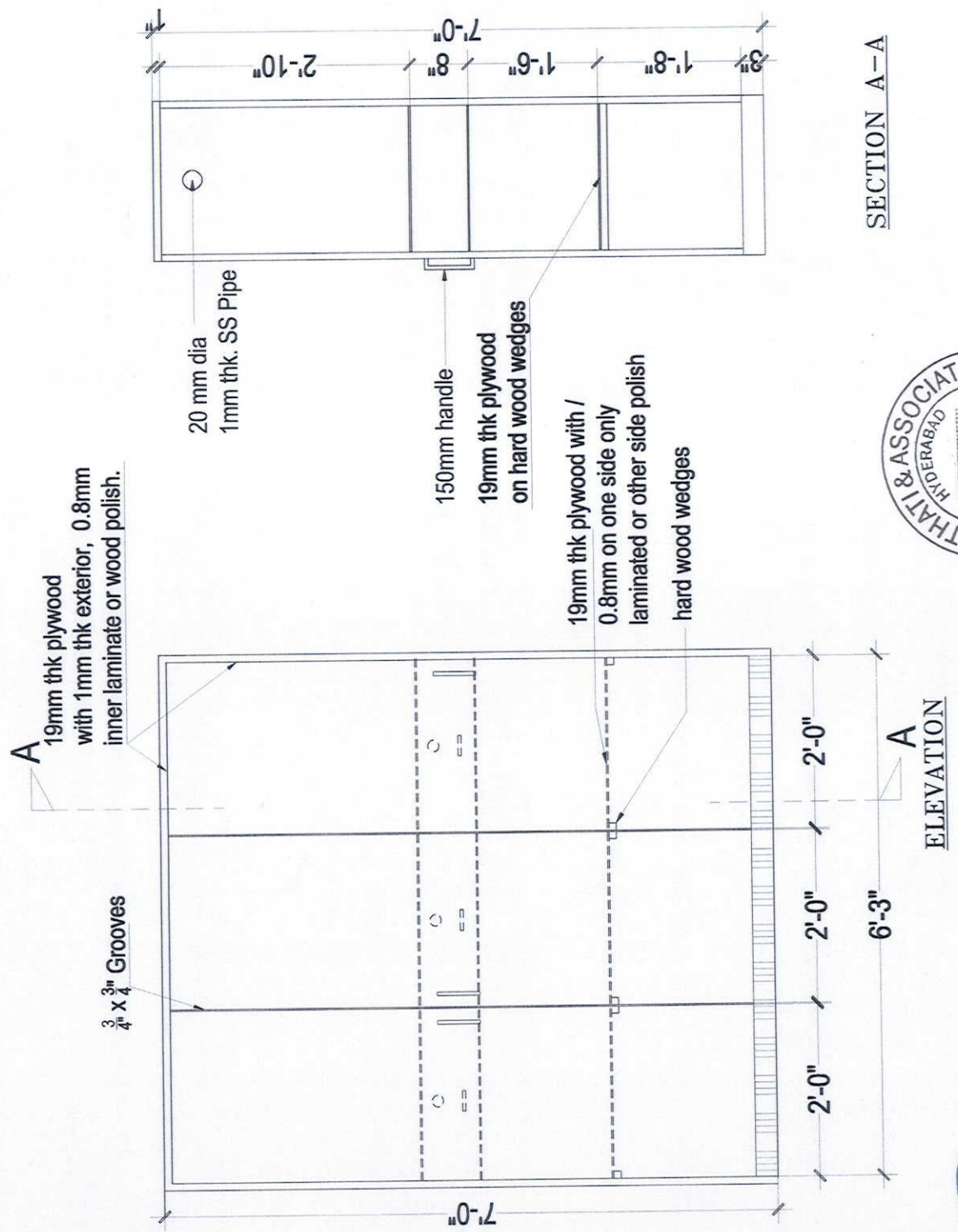

Project / Location

**PROPOSED CONSTRUCTION OF  
SIDBI QUARTERS BEGUMPET**

Client **SIDBI**

**NOTES :-**

1. ALL DIMENSIONS ARE IN FEET ONLY, UNLESS OTHERWISE SPECIFIED. (SCALE DRAWING FOLLOW FIGURED DIMENSIONS ONLY).
2. BEFORE EXECUTION OF WORK DIMENSION TO BE CHECKED AT SITE THOROUGHLY.

**NOTES :-**

1. Unless otherwise specified only BWR grade conforming to IS : 303 is to be used.
2. All the internal surfaces of BWR Plywood is to be provided with 0.8mm laminate, unless otherwise specified.
3. All the external surfaces of BWR Plywood is to be provided with 1.0mm laminate, unless otherwise specified.

4			
3			
2			
1			

REV. NO.	DESCRIPTION OF REVISION	DATE	BY
----------	-------------------------	------	----

Purpose : **FOR TENDER**

Architect :



Title : **WARD ROBE**

Dwg.No:- **BKTRASIDBI/AR-04**

North	Date	Scale	Job No.	Sheet	Rev
	10-03-15	N.T.S			
	Drawn By	Desig	Checked By	Approved By	
	UMESH	DSR	BKT	BKT	

MR. BK THATI & ASSOCIATES ARCHITECTS/ENGINEERS HAS THE COPY RIGHTS OF THIS DOCUMENT AND IT IS NOT TO BE REPRODUCED OR TRANSMITTED IN ANY FORM OR BY ANY MEANS, WITHOUT THE WRITTEN PERMISSION OF THE ARCHITECT & ASSOCIATES.

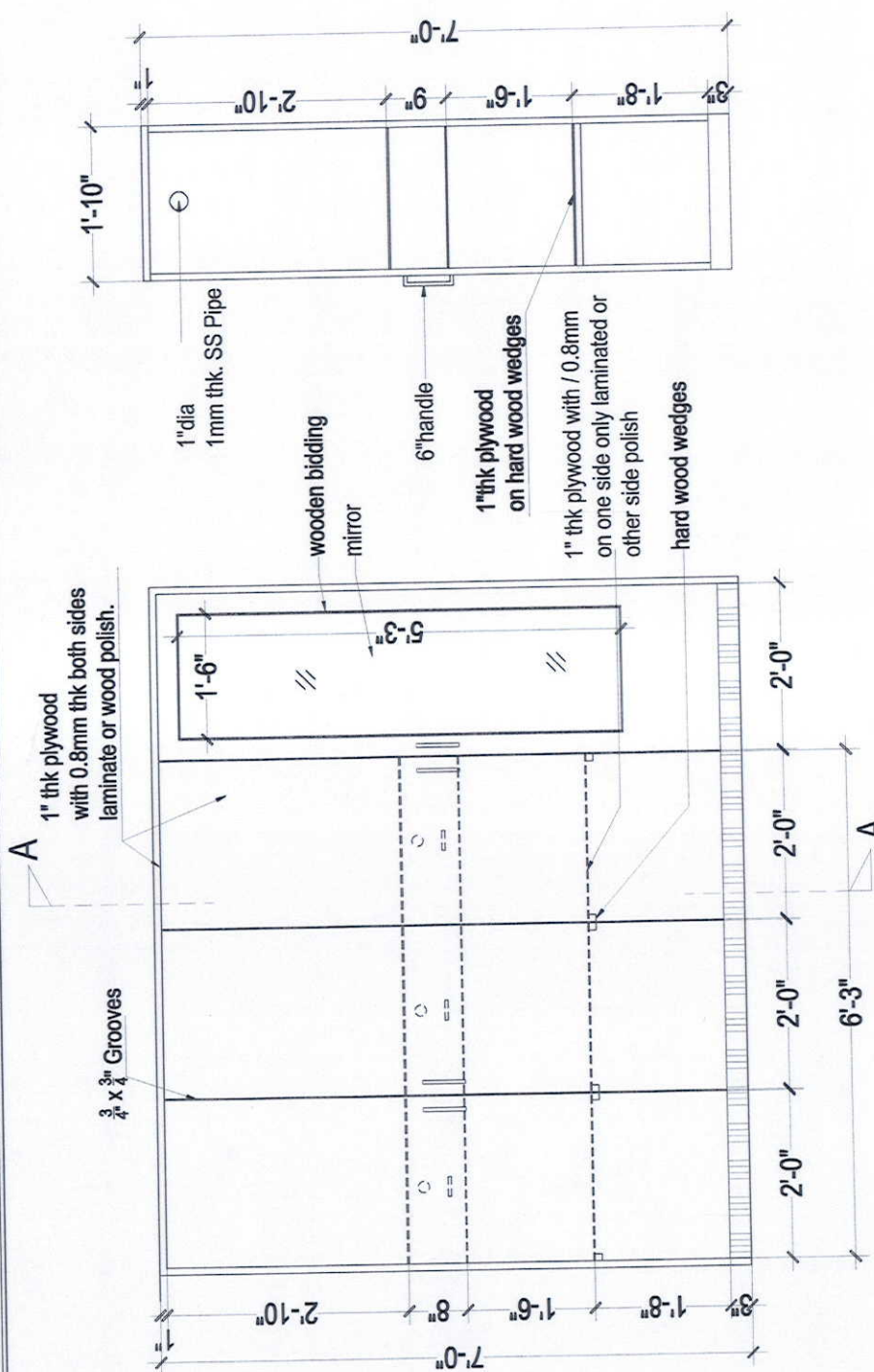

**SECTION A - A**

1" thk plywood with 0.8mm thk both sides laminate or wood polish.

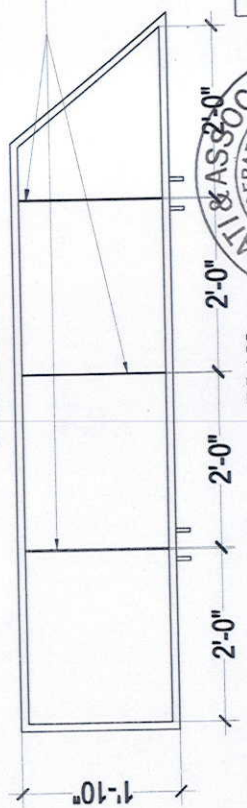

**ELEVATION**

**PLAN**

**NOTE:- FOR FLAT Nos. 13,23,33,43.**



Project / Location

**PROPOSED CONSTRUCTION OF  
SIDBI QUARTERS BEGUMPET**

Client **SIDBI**

NOTES :-

1. ALL DIMENSIONS ARE IN FEET ONLY, UNLESS OTHERWISE SPECIFIED. ALL THE DRAWING FOLLOW FIGURED DIMENSIONS ONLY.

**3. BEFORE EXECUTION OF WORK DIMENSION TO BE CHECKED AT SITE THOROUGHLY.**

NOTES :-

1. Unless otherwise specified only BWR grade conforming to IS : 303 is to be used.
2. All the internal surfaces of BWR Plywood is to be provided with 0.8mm laminate, unless otherwise specified.
3. All the external surfaces of BWR Plywood is to be provided with 1.0mm laminate, unless otherwise specified.

REVISION	NO.	DESCRIPTION OF REVISION	DATE	BY
1	1	REVISED AS PER CLIENT	26-07-16	BKT
2	2	REVISED AS PER CLIENT	30-08-16	BKT

Purpose : **FOR TENDER**

Architect : **BK THATI & ASSOCIATES**  
ARCHITECTS & ENGINEERS  
B-10/11/12/13/14/15/16/17/18/19/20/21/22/23/24/25/26/27/28/29/30/31/32/33/34/35/36/37/38/39/40/41/42/43/44/45/46/47/48/49/50/51/52/53/54/55/56/57/58/59/60/61/62/63/64/65/66/67/68/69/70/71/72/73/74/75/76/77/78/79/80/81/82/83/84/85/86/87/88/89/90/91/92/93/94/95/96/97/98/99/100

Title : **WARD ROBE FOR POOJA**

Dwg.No:- **INT-2016-04-05**

Date	Scale	Job No.	Sheet No.	Sheet Qty
10-08-16	N.T.S			
Drawn By	Checked By	Approved By		
UMESH	DKR	BKT		

Mr. BK THATI & ASSOCIATES ARCHITECTS & ENGINEERS, 100, 101, 102, 103, 104, 105, 106, 107, 108, 109, 110, 111, 112, 113, 114, 115, 116, 117, 118, 119, 120, 121, 122, 123, 124, 125, 126, 127, 128, 129, 130, 131, 132, 133, 134, 135, 136, 137, 138, 139, 140, 141, 142, 143, 144, 145, 146, 147, 148, 149, 150, 151, 152, 153, 154, 155, 156, 157, 158, 159, 160, 161, 162, 163, 164, 165, 166, 167, 168, 169, 170, 171, 172, 173, 174, 175, 176, 177, 178, 179, 180, 181, 182, 183, 184, 185, 186, 187, 188, 189, 190, 191, 192, 193, 194, 195, 196, 197, 198, 199, 200, 201, 202, 203, 204, 205, 206, 207, 208, 209, 210, 211, 212, 213, 214, 215, 216, 217, 218, 219, 220, 221, 222, 223, 224, 225, 226, 227, 228, 229, 230, 231, 232, 233, 234, 235, 236, 237, 238, 239, 240, 241, 242, 243, 244, 245, 246, 247, 248, 249, 250, 251, 252, 253, 254, 255, 256, 257, 258, 259, 260, 261, 262, 263, 264, 265, 266, 267, 268, 269, 270, 271, 272, 273, 274, 275, 276, 277, 278, 279, 280, 281, 282, 283, 284, 285, 286, 287, 288, 289, 290, 291, 292, 293, 294, 295, 296, 297, 298, 299, 300, 301, 302, 303, 304, 305, 306, 307, 308, 309, 310, 311, 312, 313, 314, 315, 316, 317, 318, 319, 320, 321, 322, 323, 324, 325, 326, 327, 328, 329, 330, 331, 332, 333, 334, 335, 336, 337, 338, 339, 340, 341, 342, 343, 344, 345, 346, 347, 348, 349, 350, 351, 352, 353, 354, 355, 356, 357, 358, 359, 360, 361, 362, 363, 364, 365, 366, 367, 368, 369, 370, 371, 372, 373, 374, 375, 376, 377, 378, 379, 380, 381, 382, 383, 384, 385, 386, 387, 388, 389, 390, 391, 392, 393, 394, 395, 396, 397, 398, 399, 400, 401, 402, 403, 404, 405, 406, 407, 408, 409, 410, 411, 412, 413, 414, 415, 416, 417, 418, 419, 420, 421, 422, 423, 424, 425, 426, 427, 428, 429, 430, 431, 432, 433, 434, 435, 436, 437, 438, 439, 440, 441, 442, 443, 444, 445, 446, 447, 448, 449, 450, 451, 452, 453, 454, 455, 456, 457, 458, 459, 460, 461, 462, 463, 464, 465, 466, 467, 468, 469, 470, 471, 472, 473, 474, 475, 476, 477, 478, 479, 480, 481, 482, 483, 484, 485, 486, 487, 488, 489, 490, 491, 492, 493, 494, 495, 496, 497, 498, 499, 500, 501, 502, 503, 504, 505, 506, 507, 508, 509, 510, 511, 512, 513, 514, 515, 516, 517, 518, 519, 520, 521, 522, 523, 524, 525, 526, 527, 528, 529, 530, 531, 532, 533, 534, 535, 536, 537, 538, 539, 540, 541, 542, 543, 544, 545, 546, 547, 548, 549, 550, 551, 552, 553, 554, 555, 556, 557, 558, 559, 560, 561, 562, 563, 564, 565, 566, 567, 568, 569, 570, 571, 572, 573, 574, 575, 576, 577, 578, 579, 580, 581, 582, 583, 584, 585, 586, 587, 588, 589, 590, 591, 592, 593, 594, 595, 596, 597, 598, 599, 600, 601, 602, 603, 604, 605, 606, 607, 608, 609, 610, 611, 612, 613, 614, 615, 616, 617, 618, 619, 620, 621, 622, 623, 624, 625, 626, 627, 628, 629, 630, 631, 632, 633, 634, 635, 636, 637, 638, 639, 640, 641, 642, 643, 644, 645, 646, 647, 648, 649, 650, 651, 652, 653, 654, 655, 656, 657, 658, 659, 660, 661, 662, 663, 664, 665, 666, 667, 668, 669, 670, 671, 672, 673, 674, 675, 676, 677, 678, 679, 680, 681, 682, 683, 684, 685, 686, 687, 688, 689, 690, 691, 692, 693, 694, 695, 696, 697, 698, 699, 700, 701, 702, 703, 704, 705, 706, 707, 708, 709, 710, 711, 712, 713, 714, 715, 716, 717, 718, 719, 720, 721, 722, 723, 724, 725, 726, 727, 728, 729, 730, 731, 732, 733, 734, 735, 736, 737, 738, 739, 740, 741, 742, 743, 744, 745, 746, 747, 748, 749, 750, 751, 752, 753, 754, 755, 756, 757, 758, 759, 760, 761, 762, 763, 764, 765, 766, 767, 768, 769, 770, 771, 772, 773, 774, 775, 776, 777, 778, 779, 780, 781, 782, 783, 784, 785, 786, 787, 788, 789, 790, 791, 792, 793, 794, 795, 796, 797, 798, 799, 800, 801, 802, 803, 804, 805, 806, 807, 808, 809, 810, 811, 812, 813, 814, 815, 816, 817, 818, 819, 820, 821, 822, 823, 824, 825, 826, 827, 828, 829, 830, 831, 832, 833, 834, 835, 836, 837, 838, 839, 840, 841, 842, 843, 844, 845, 846, 847, 848, 849, 850, 851, 852, 853, 854, 855, 856, 857, 858, 859, 860, 861, 862, 863, 864, 865, 866, 867, 868, 869, 870, 871, 872, 873, 874, 875, 876, 877, 878, 879, 880, 881, 882, 883, 884, 885, 886, 887, 888, 889, 890, 891, 892, 893, 894, 895, 896, 897, 898, 899, 900, 901, 902, 903, 904, 905, 906, 907, 908, 909, 910, 911, 912, 913, 914, 915, 916, 917, 918, 919, 920, 921, 922, 923, 924, 925, 926, 927, 928, 929, 930, 931, 932, 933, 934, 935, 936, 937, 938, 939, 940, 941, 942, 943, 944, 945, 946, 947, 948, 949, 950, 951, 952, 953, 954, 955, 956, 957, 958, 959, 960, 961, 962, 963, 964, 965, 966, 967, 968, 969, 970, 971, 972, 973, 974, 975, 976, 977, 978, 979, 980, 981, 982, 983, 984, 985, 986, 987, 988, 989, 990, 991, 992, 993, 994, 995, 996, 997, 998, 999, 1000

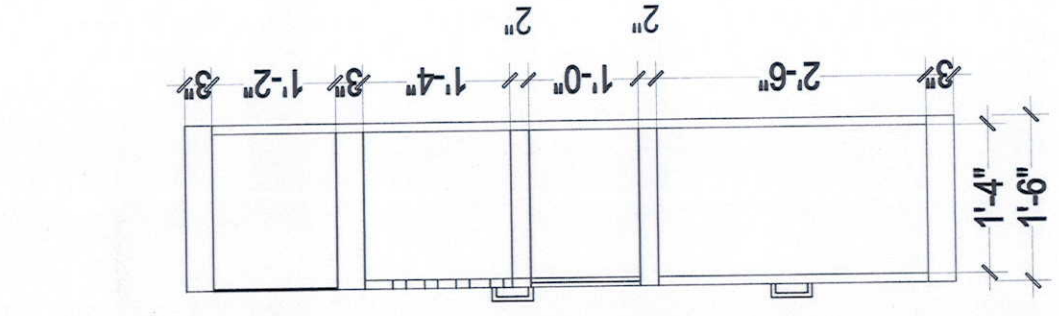

**SECTION A-A**

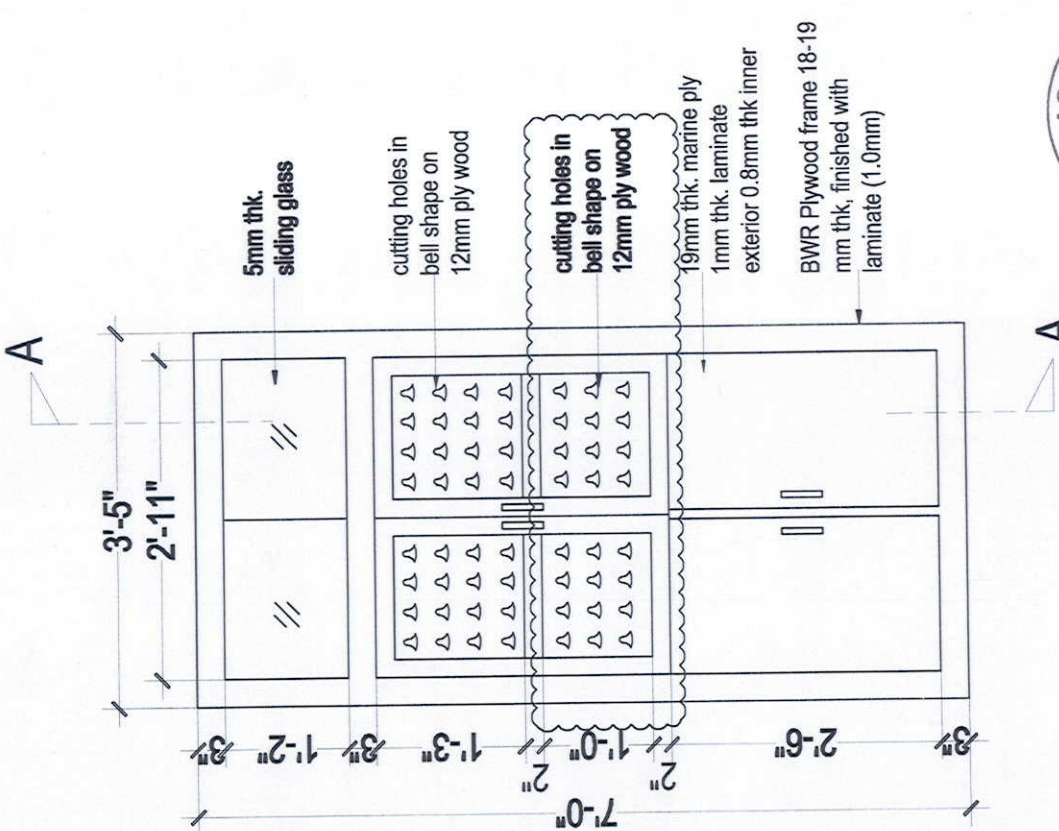

**ELEVATION**



Project / Location

**PROPOSED CONSTRUCTION OF  
SIDBI QUARTERS BEGUNIPET**

Client

SIDBI

NOTES :-

1. ALL DIMENSIONS ARE IN FEET ONLY, UNLESS OTHERWISE SPECIFIED.
2. DO NOT SCALE THE DRAWING FOLLOW FIGURED DIMENSIONS ONLY.
3. BEFORE EXECUTION OF WORK DIMENSION TO BE CHECKED AT SITE THOROUGHLY.

NOTES :-

1. Unless otherwise specified only BWR grade conforming to IS : 303 is to be used.
2. All the internal surfaces of BWR Plywood is to be provided with 0.8mm laminate, unless otherwise specified.
3. All the external surfaces of BWR Plywood is to be provided with 1.0mm laminate, unless otherwise specified.

REVISION NO.	DESCRIPTION OF REVISION	DATE	BY
1	REVISED AS PER CLIENT	28-07-16	BKT
2	REVISED AS PER CLIENT	09-09-16	BKT

Purpose : **FOR TENDER**

Architect :

**BK THATI & ASSOCIATES**  
 ARCHITECTS & ENGINEERS  
 10-08-16, N.T.B  
 DUBLI, HYDRABAD  
 TEL: 01-26100000  
 FAX: 01-26100001  
 WWW.BKTHATI.COM

Title :

SHOW CASE

Drwg.No:- BKTHATI/2016/04/05

North	Date	Scale	Job No.	Sheet	Rev
	10-08-16	N.T.B			
	Drawn By	Desk	Checked	Approved	By
	LAMISH	DKR	BKT		

This is a preliminary drawing and is not to be used for construction without the written permission of BK THATI & ASSOCIATES.

